

DRC

PZ24-12000027

04/16/2025

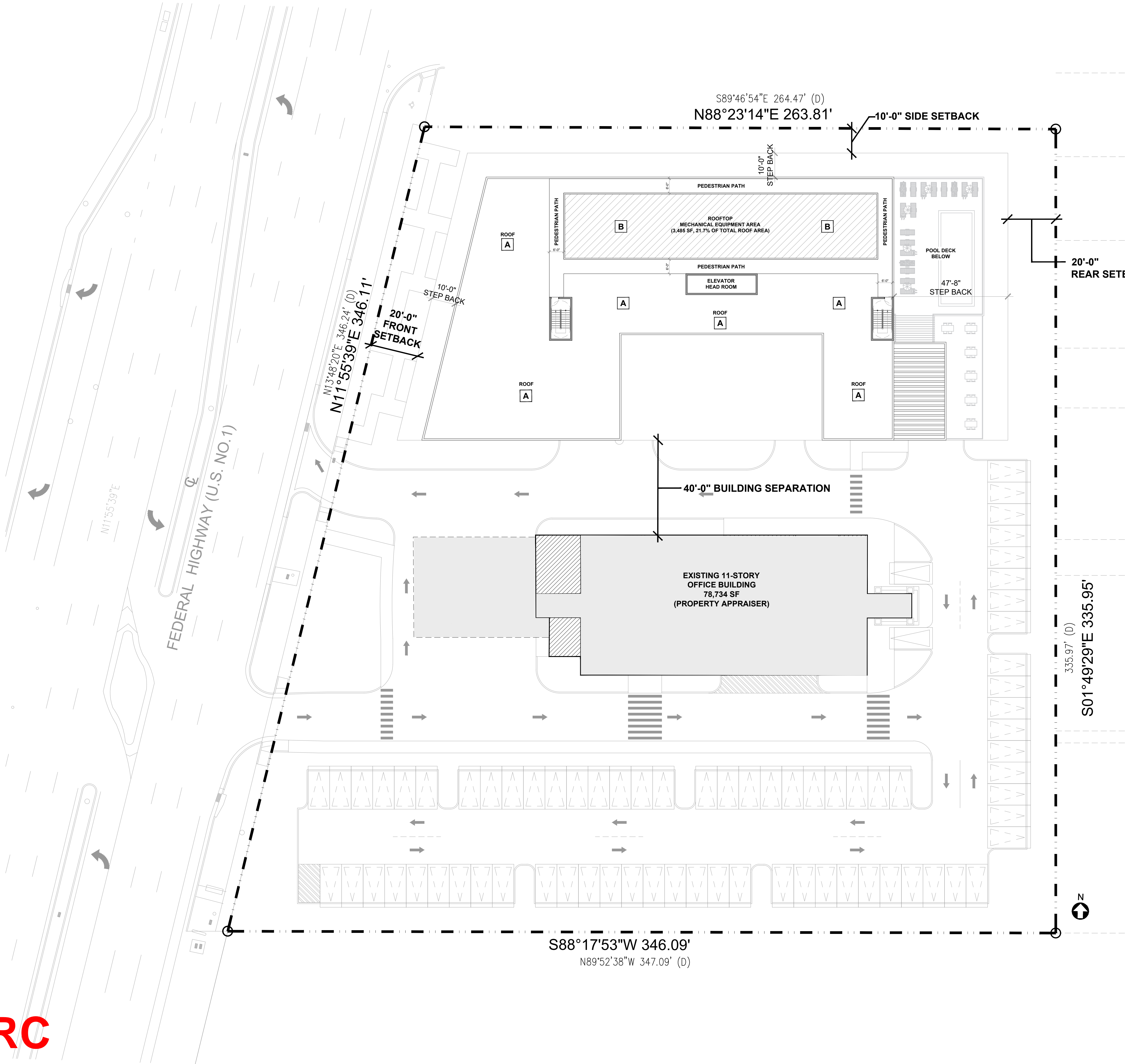

ROOFTOP MECHANICAL EQUIPMENT SCREEN

ROOF PLAN KEYNOTES & LEGEND	
A	WHITE ROOF MEMBRANE
B	ROOFTOP MECHANICAL EQUIPMENT AREA
	ROOFTOP MECHANICAL EQUIPMENT COVERAGE AREA = 3,485 SF (21.7% OF TOTAL ROOF AREA)

idea

Architect

absolute-idea.com  
CANAL PARK  
3323 NE 163rd Street, Suite 200 North Miami Beach, FL 33160  
T 305.792.0015 T 305.931.0279 @info@absolute-idea.com

SEAL

TO THE BEST OF MY KNOWLEDGE, THE PLANS AND SPECIFICATIONS COMPLY WITH THE APPLICABLE MINIMUM BUILDING CODES AND THE APPLICABLE FIRE-SAFETY STANDARDS AS DETERMINED BY THE LOCAL AUTHORITY IN ACCORDANCE WITH THIS SECTION AND 633 FLORIDA STATUTES.

STEPHANE L'ECUYER  
AR 93637

STATE OF FLORIDA

STEPHANE L'ECUYER

AR 93637

REGISTERED ARCHITECT

ISSUE FOR:  
DRC SUBMITTAL

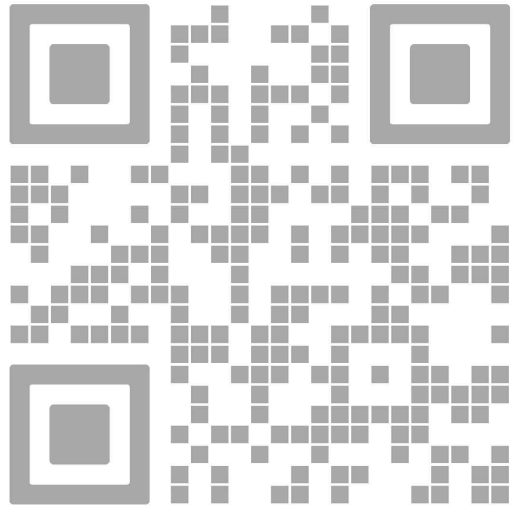

REV.	DATE	DESCRIPTION
01	01-29-2025	D.R.C. SUBMITTAL

ALL MEASUREMENTS MUST BE VERIFIED BEFORE BEGINNING THE WORK. NO MEASUREMENTS ARE TO BE SCALED DIRECTLY FROM THIS DRAWING.

Key section

A diagram showing a key section of the building, with horizontal lines representing the building's profile and a vertical line indicating the section cut.

Client  
**VERA FUND**  
NICK POLYUSHKIN  
& YURI KHARITONENKOV  
TEL: 305.833.3303

Project  
**1600 S FEDERAL HIGHWAY (MIXED-USE PROJECT)**  
1600 SOUTH FEDERAL HIGHWAY,  
POMPAHO BEACH, FL 33062

Title	
ROOF PLAN	
Drawn <b>J. WU</b>	Field <b>ARCHITECTURE</b>
Verified <b>N. TREMBLAY</b>	Scale <b>as shown</b>
Approved <b>S. L'ECUYER</b>	Date <b>03-12-2025</b>
Project Manager <b>J. WU</b>	Dwg. no. <b>A-207</b>
Project <b>24-838</b>	